

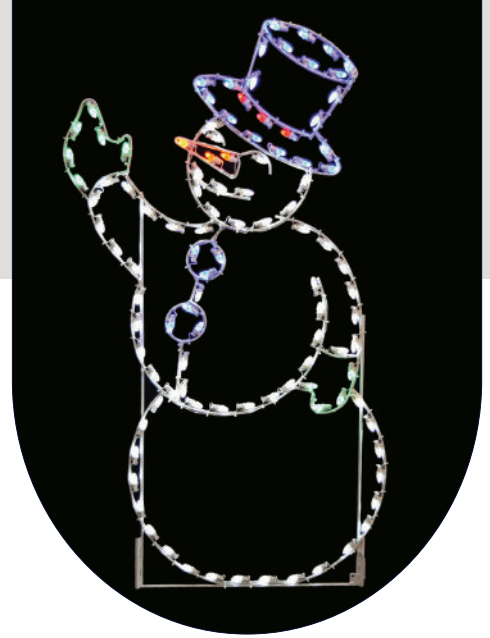

# Assembly Instructions

## 8' and Under Ground Mounts



### 8' and Under Ground Mounts with Female Pipe Receptacle

This particular ground mount style is designed for decorations up to 8 feet tall. It features built-in female pipe receptacles at the base of the decoration. It easily slides over a pipe stand for secure mounting. This design not only simplifies installation but also ensures stability and durability, making it an excellent choice for smaller displays.

#### NECESSARY COMPONENTS

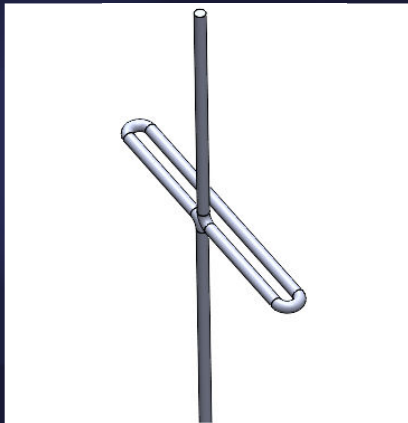

8" T-Stand



Guy Kit

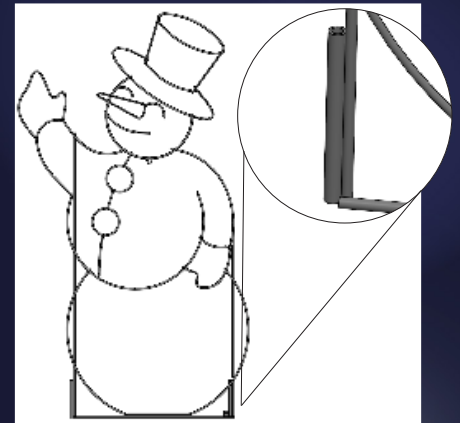

Female Pipe Receptacles

## Step One

### Position Decoration & Set Up Stands

Begin by deciding where you want your decoration to face. This will help guide the placement of the stands for a stable setup.

Identify the spots at the base of the decoration where each stand will be inserted. Use your foot to gently press each stand down into the ground at these points.

Ensure the flat sides of the stands are facing front and back. This orientation is essential, as it provides stability by preventing the decoration from tilting forward or backward. (1a.)

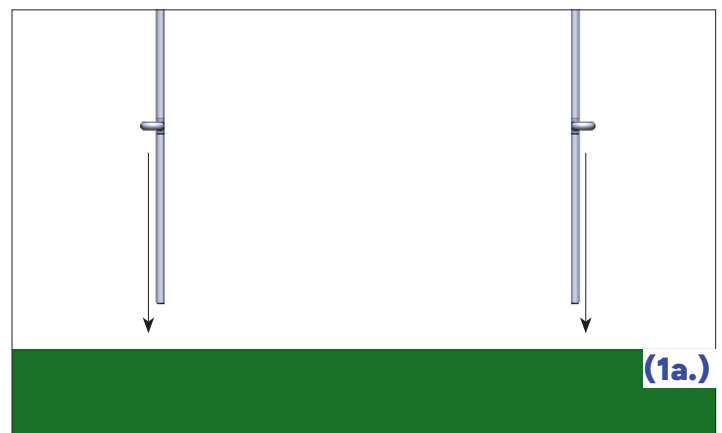



# Assembly Instructions

## 8' and Under Ground Mounts

### Step Two

#### Attach Decoration to Stands & Guy Down

Carefully lift the decoration and slide the female pipe receptacles at the base down over the prongs of the stands, ensuring a secure fit.

Use provided guy wires to anchor the decoration. This will help keep it steady in windy conditions.

Finally, connect the decoration's electrical leads to your power source, ensuring all connections are secure for safe operation.

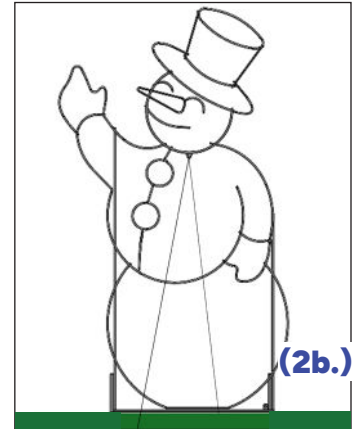
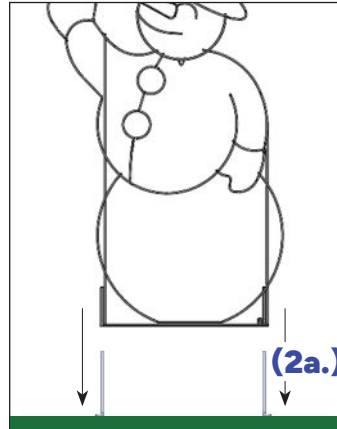

*Thank you for choosing us to bring holiday joy and light to your display. For more information about our products, please contact your design consultant. You can also visit our website to explore additional decorations and see what's new this season.*

*We're grateful for the opportunity to be part of your holiday celebrations.*

*- The Holiday Outdoor Decor Family*

